



Octagon & Oval Wood Gazebos



2017 Price List



Standard Features: • ACQ Pressure Treated Wood • Dimensional Shingle Roof • 1x6 Cedar Sheathing
• Constructed with Screws • Straight Floor • Cupola

Gazebo Sizes	Styles						Options															
	Classic	Victorian	Colonial	Heavy Duty Colonial	Brookside	Three Season <small>(Includes Window Enclosure)</small>	Octagon Floor (Pie shaped)	1" Veka Floor on Wood Gazebo* <small>(Includes Octagon Shape Feet)</small>	White Beaded Ceiling	Curved Roof with Asphalt Shingles	Treated Cedar Shakes	Curved Roof with Treated Cedar Shakes	Steel Roof	Aluminum Frame Screening <small>(Includes Self-Closing Door)</small>	Window Enclosure	On Site Construction <small>(Plus Delivery)</small>	Constructing Platform to Set Gazebo On**	Treating Complete Gazebo with Wood Protector	Paint Gazebo White	Benches <small>(Per Section)</small>	Available Without Floor to Set on your Deck	
8'	2,616	2,856	3,039	3,104	3,223	NA	174	469	393	298	476	520	426	NA	NA	497	1,151	348	436	34	-229	Wooden Steps to Match Railing on Gazebo 2 Steps . . . 304 3 Steps . . . 355 4 Steps . . . 403
10'	3,133	3,366	3,539	3,637	3,713	6,052		605	471	342	547	592	512	995	3,922	540	1,313	391	478	36	-255	
12'	3,756	3,990	4,177	4,320	4,324	6,773		732	653	449	624	731	592	1,182	4,148	582	1,477	436	521	38	-319	
12' w/ Double Roof 12' w/ Double	4,347	4,583	4,772	4,911	4,914	7,920									4,904							
14'	4,999	5,314	5,572	5,766	5,772	8,701									5,173	758	1,966	592	710	46	-332	
14' w/ Double Roof 14' w/ Double	5,810	6,130	6,387	6,579	6,586	10,208									6,133							
16'	6,430	6,852	7,179	7,431	7,441	11,021									6,470	957	2,531	772	927	59	-433	
16' w/ Double Roof 16' w/ Double	7,497	7,916	8,245	8,494	8,505	12,965									7,692							
18'	8,098	8,624	9,048	9,367	9,378	14,482									8,876	1,288	3,277	982	1,175	47	-547	
18' w/ Double Roof 18' w/ Double	9,429	9,959	10,383	10,700	10,707	17,064									10,581							
20'	9,927	10,581	11,099	11,495	11,509	17,733								10,871	1,586	4,037	1,209	1,450	59	-676		
20' w/ Double Roof 20' w/ Double	11,573	12,227	12,750	13,142	13,151	20,918								12,971								
10' x 14'	3,817	4,047	4,278	4,417	4,527	7,667	NA	749	572	449	633	731	553	1,235	5,139	581	1,616	436	521		-319	
10' x 16'	4,433	4,646	4,898	5,053	5,130	8,460		826	666	521	762	868	632	1,408	5,456	581	1,772	521	610	36	-345	
10' x 18'	5,246	5,477	5,715	5,890	5,948	9,420		909	788	601	928	1,037	710	1,578	5,769	581	1,933	610	696		-371	
12' x 16'	5,767	5,941	6,115	6,301	6,289	9,864		962	976	647	1,039	1,067	749	1,455	5,769	581	1,841	521	696		-371	
12' x 16' w/ Double Roof	6,508	6,682	6,855	7,042	7,032	11,410									6,852							
12' x 18'	6,440	6,635	6,834	7,046	7,029	10,572		1,019	1,092	729	1,169	1,199	827	1,599	5,931	581	1,989	610	740	38	-388	
12' x 18' w/ Double Roof	7,274	7,469	7,666	7,877	7,862	12,225									7,042							
12' x 20'	7,127	7,344	7,560	7,796	7,775	11,287		1,118	1,208	809	1,297	1,333	906	1,750	6,088	581	2,150	696	784		-408	Teahouse w/ Rose Swing
12' x 20' w/ Double Roof	8,051	8,269	8,488	8,720	8,706	13,048									7,235							
7' x 9'4" Teahouse w/ 1 Opening	2,838	2,838	3,054	3,119	3,272	NA		469	450	NC	NC	NC	426	NA	NA	497	1,151	348	436	34	-229	Add:
7' x 9'4" Teahouse w/ Dbl. Swing	2,998	2,998	3,214	3,280	3,433														NC		65	

** Up to 3' High, and Includes Lattice Around Bottom. Also Includes On Site Construction.

Free Delivery within 30 Miles
After 30 Miles - \$3.00 a mile one way
Prices subject to change without notice!

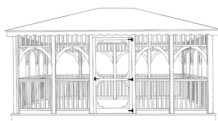

Square & Rectangular

Wood Gazebos



2017 Price List



330-332-9940

Standard Features: • ACQ Pressure Treated Wood • Dimensional Shingle Roof
• 1x6 Cedar Sheathing • Constructed with Screws • Straight Floor

Gazebo Sizes	Styles								Options													
	Classic	Victorian	Colonial	Heavy Duty Colonial	Brookside	Three Season <small>(Includes Window Enclosure)</small>	Outdoor Kitchen	Pavilion	Wood Cupola	1" Veka™ Floor on Wood Gazebo*	White Beaded Ceiling	Treated Cedar Shakes	Steel Roof	Aluminum Frame Screening <small>(Includes Self-Closing Door)</small>	Window Enclosure	On Site Construction <small>(Plus Delivery)</small>	Constructing Platform to Set Gazebo On**	Treating Complete Gazebo with Wood Protector	Paint Gazebo White	Benches (Per Section)		Available Without Floor to Set on your Deck
8'	3,133	3,366	3,539	3,637	3,713	NA	NA	2,916	174	468	471	547	512	NA	NA	540	1,292	348	436	34	-255	Steps to Match Railing on Gazebo 2 Steps . . . 304 3 Steps . . . 355 4 Steps . . . 403
10'	3,340	3,530	3,723	3,840	3,931	6,586	6,586	3,106		732	501	564	592	1,036	4,343	582	1,373	391	478	36	-286	
12'	4,837	4,984	5,135	5,296	5,285	8,416	8,416	4,501		962	836	891	749	1,253	5,000	628	1,555	478	653	38	-332	
12' w/ Double Roof	5,576	5,725	5,873	6,035	6,024	9,832	NA	5,239							5,925							
14'	6,430	6,852	7,179	7,431	7,358	10,422	10,422	5,980		1,179	1,089	1,109	906	2,061	5,767	957	2,531	772	927	46	-433	
14' w/ Double Roof	7,263	7,686	8,013	8,262	8,187	12,048	NA	6,813							6,848							
16'	8,303	8,853	9,281	9,607	9,625	13,189	13,189	7,723		1,538	1,385	1,450	1,024	2,532	7,147	1,088	3,028	859	1,014	59	-459	
16' w/ Double Roof	9,227	9,779	10,209	10,537	10,550	15,128	NA	8,648							8,503							
18'	10,533	10,864	11,202	11,566	11,541	18,182	18,182	9,797		1,949	1,829	2,005	1,143	2,817	10,791	1,390	3,455	1,076	1,466	47	-579	
18' w/ Double Roof	12,194	12,531	12,864	13,229	13,204	21,366	NA	11,460							12,877							
20'	12,932	13,345	13,762	14,209	14,180	22,298	22,298	12,029	2,405	2,248	2,475	1,300	3,479	13,234	1,712	4,256	1,329	1,814	59	-717		
20' w/ Double Roof	14,984	15,396	15,813	16,263	16,231	26,230	NA	14,079						15,809								
10' x 12'	3,767	3,998	4,229	4,372	4,477	7,627	7,627	3,505	217	909	566	633	553	1,235	5,139	629	1,617	436	521	36	-319	Boots for Pavilion 69
10' x 14'	4,384	4,599	4,853	5,006	5,082	8,420	8,420	4,078	261	962	658	762	632	1,408	5,456	629	1,772	521	610		-345	
10' x 16'	5,197	5,429	5,665	5,841	5,899	9,377	9,377	4,833	304	1,019	780	928	710	1,578	5,769	629	1,932	610	696	38	-371	4' Double Swing 391 Teahouse w/ Rose Swing Add: 65
10' x 18'	5,836	6,097	6,364	6,562	6,626	10,496	10,496	5,429	348	1,118	875	1,044	788	1,732	6,449	629	2,124	653	740		-396	
12' x 14'	5,719	5,893	6,066	6,254	6,241	9,820	9,820	5,318	217	1,044	969	1,039	710	1,455	5,769	629	1,841	521	696	38	-357	
12' x 14' w/ Double Roof	6,460	6,633	6,804	6,994	6,981	11,369	NA	6,061						6,851								
12' x 16'	6,393	6,588	6,787	6,997	6,984	10,531	10,531	5,946	261	1,191	1,084	1,169	788	1,599	5,931	629	1,989	610	740	38	-382	
12' x 16' w/ Double Roof	7,225	7,422	7,618	7,829	7,813	12,185	NA	6,777						7,042								
12' x 18'	7,077	7,296	7,510	7,747	7,729	11,246	11,246	6,583	304	1,342	1,200	1,297	867	1,750	6,088	629	2,150	696	784	38	-408	
12' x 18' w/ Double Roof	8,002	8,221	8,440	8,675	8,655	13,004	NA	7,506						7,232								
12' x 20'	7,851	8,094	8,336	8,596	8,575	12,444	12,444	7,302	348	1,491	1,330	1,440	946	1,938	6,724	629	2,340	784	826	38	-433	
12' x 20' w/ Double Roof	8,865	9,107	9,351	9,610	9,556	14,386	NA	8,316						7,994								

** Up to 3' High, and Includes Lattice Around Bottom. Also Includes On Site Construction.

Free Delivery within 30 Miles
After 30 Miles - \$3.00 a mile one way
Prices subject to change without notice!